

**Wall bracket of the TTE for wall fastening**

Type	TTE/ TTD 50	TTE/ TTD 100	TTE/ TTD 250	TTE/ TTD 500	TTE/ TTD 750	TTE/ TTD 990
Length WK (mm)	300	500			750	
Type of wall bracket	WK 1	WK 2			WK 3	
Weight/pair	10 kg	12 kg			18 kg	

The wall brackets are fixed to the two fixing holes in the front wall area of the tank. After this the tank with the wall brackets will be positioned on the wall. Drill the wall and fix the tank with proper dowels. (Proof of bearing capacity and mounting system are provided by customer.)

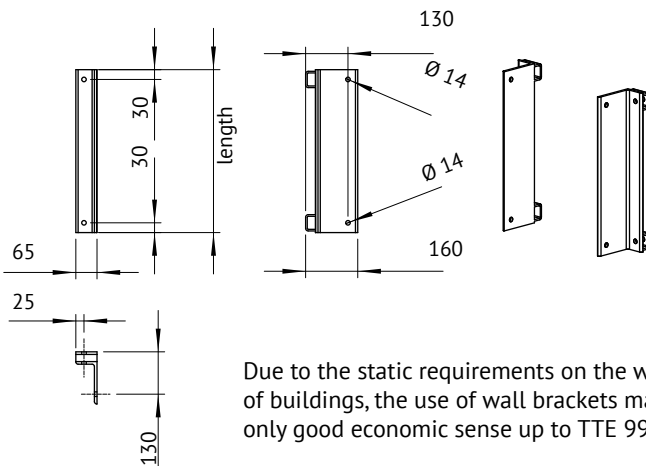

Due to the static requirements on the wall of buildings, the use of wall brackets makes only good economic sense up to TTE 990.

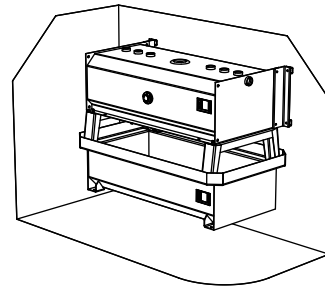

Example of use:  
TTE 500 day tank single wall  
with TW 500 catch sump and  
WK 2 wall bracket

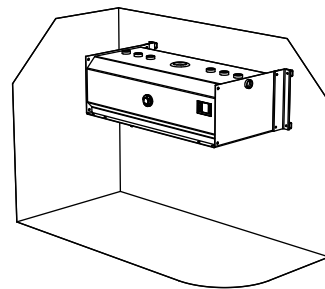

Example of Use:  
TTD 500 day tank double wall  
with WK 2 wall brackets

**Feet for TTE and TTD for direct setup on the ground**

Type	TTE/ TTD 50	TTE/ TTD 100	TTE/ TTD 250	TTE/ TTD 500	TTE/ TTD 750	TTE/ TTD 990	TTE/ TTD 1500	TTE/ TTD 1950
Length foot (mm)	500			750		1000	1250	
Type of foot	FS 1			FS 2		FS 3	FS 4	
Weight/pair	9 kg			14 kg		16 kg	18 kg	

The feet consists of a pair of square pipes with a height of 100 mm made of steel. They are equipped with welded studs M10 and nuts M10 with undetachable washers. They serve the optimal setup of the day tank and the catch sump on the ground.

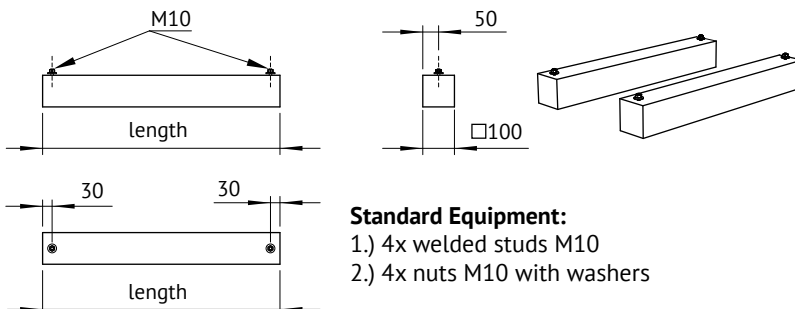
**Standard Equipment:**

- 1.) 4x welded studs M10
- 2.) 4x nuts M10 with washers

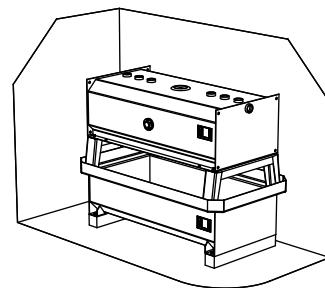

Example of use:  
TTD 500 day tank single wall with TW 500  
catch sump and FS 2 foot

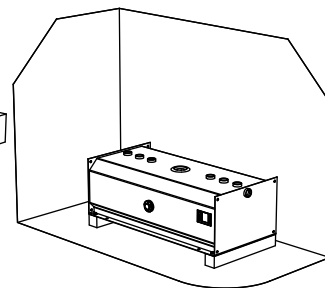

Example of use:  
TTD 500 day tank double wall  
with FS 2 foot

Material	Approval	Documentation	Sheet
Steel S235JR			1 / 2

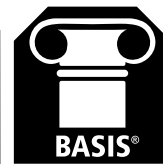

### Stand column ST 1, 2, 3, 4 for TTE and TTD for raised setup on the ground up to TTE/TTD 990

The stand column consists of a construction with two stands which are made of a square pipe with the dimensions 100x100x3 mm. The supports are screwed with a cross girder on two face plates by using four nuts for each. After this, the catch sump and the day tank are lifted on the stand column and they are inserted with proper weld studs and fixed with four nuts M10 and undetachable washers. In the end the openings of the square pipes are closed with any closing caps.

Type	TTE 50/100	Weight (kg)	TTE/TTD 250	Weight (kg)	TTE/TTD 500/750	Weight (kg)	TTE/TTD 990	Weight (kg)
Length ST (mm)	500		1250		1500		2000	
Width ST (mm)	500		500		750		750	
Height of the ST	Type of stand column							
500 mm	ST 1/5	30	ST 2/5	37	ST 3/5	48	ST 4/5	53
1,000 mm	ST 1/10	34	ST 2/10	46	ST 3/10	57	ST 4/10	62
1,500 mm	ST 1/15	38	ST 2/15	55	ST 3/15	66	ST 4/15	71

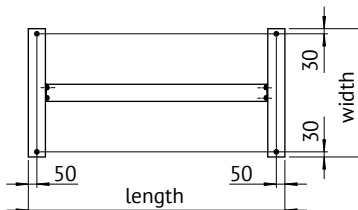
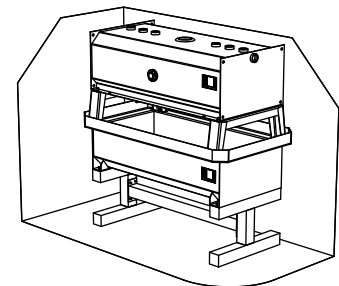
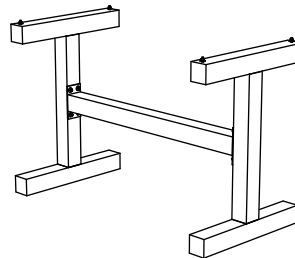
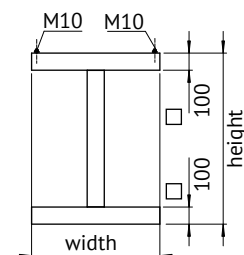
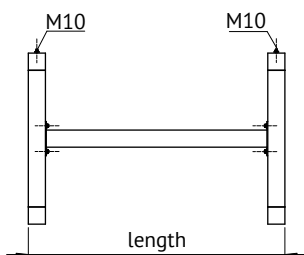

#### Standard Equipment:

- 1.) 2x supports with 6x weld studs M10 for each
- 2.) 12x nuts M10 with undetachable washers
- 3.) 1x distance piece with 2x face plates

Example of use:  
TTE 500 day tank single wall  
with TW 500 catch sump and  
ST 3/5 stand column

### Stand column ST 5, 6 for TTE and TTD for raised setup on the ground for TTE/TTD 1500–1950

Type	TTE/ TTD 1500	Weight (kg)	TTE/ TTD 1950	Weight (kg)
Length ST (mm)	2000		2000	
Width ST (mm)	1000		1250	
Height of the ST	Type of stand column			
500 mm	ST 5/5	81	ST 6/5	90
1.000 mm	ST 5/10	99	ST 6/10	108
1.500 mm	ST 5/15	117	ST 6/15	125

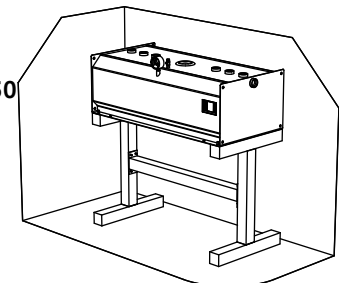
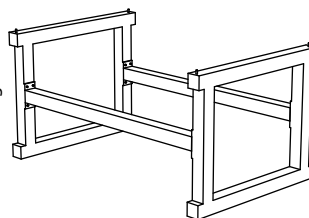
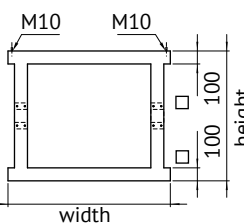
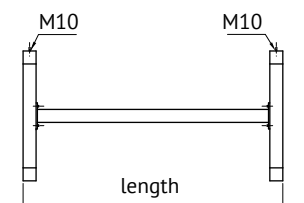

Example of use:  
TTD 500 day tank double wall  
with ST3/5 stand column

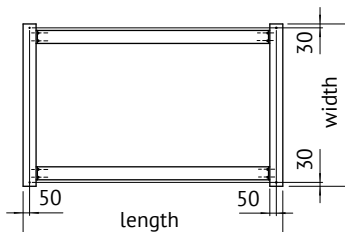

#### Standard Equipment:

- 1.) 2x supports with 10x weld studs M10 for each
- 2.) 20x nuts M10 with undetachable washers
- 3.) 2x distance pieces with 2x face plates

Example of use:  
TTD 1500 day tank double wall  
with ST5/5 stand column

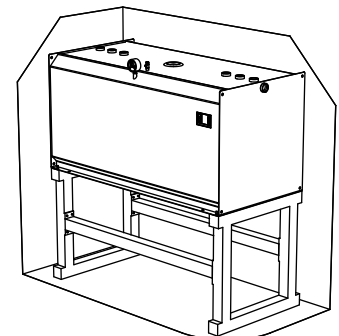

Material	Approval	Documentation	Sheet
Steel S235JR			1 / 2