

**BFS-**





## Filling and removal box

### Usage and functionality



**Krampitz**  
TANKSYSTEM  
GMBH



Characteristic	Area of use / media				Installation
					
E12 hazardous to ground water	E5 flash point > 55°C		E24 safe against floods		E8 outdoor installation

The filling and disposal cabinet is a safety equipment for easy installation of the tank truck connections with limit value transmitter plug and overflow confirmation box. This indicates when the maximum fill level in the tank is reached with the aid of an overflow protection device and a measuring transducer (both available separately), it issues a visual and audible alarm. The visual alarm is given by means of a flashing light on the roof of the box or a visual alarm by means of a horn in the housing. The alarm can be switched off or confirmed by the alarm confirmation button located in the middle of the housing. On the bottom of the filling and disposal cabinet is a removable drip tray for collecting small drip quantities from the tank truck connection.

The filling and disposal cabinet can be used for refueling diesel, heating oil, fresh oil or, in the stainless steel version, also for urea solution. It can also be equipped with suction nozzles for waste oil. The closing door guarantees access to the tanker connections only for instructed personnel. Furthermore, the connection fittings are weather-protected enclosed.

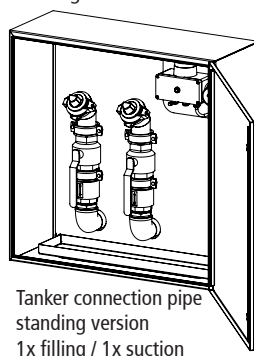
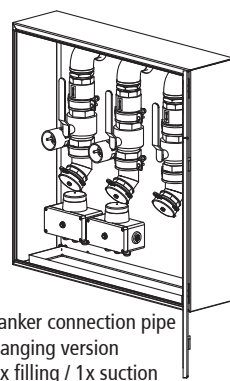
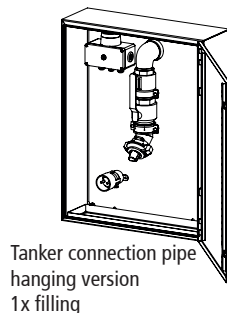
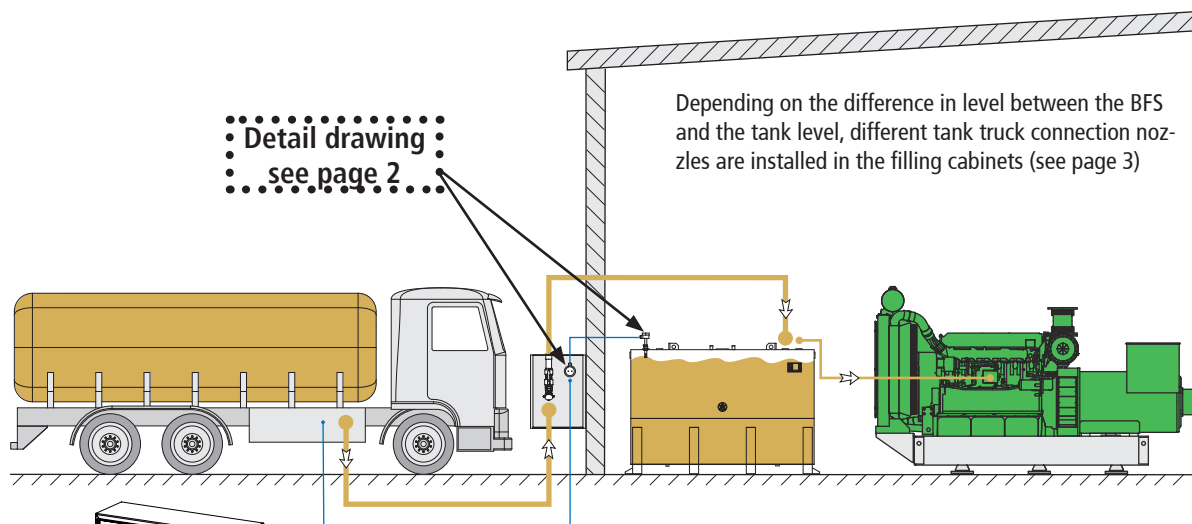

#### Standard equipment:

- Tanker connections designed in nominal width DN50/2"
- Fitting group of the tank truck connection consists of the male part of the tank truck coupling as well as a ball valve as a shut-off fitting and a following check valve
- Couplings from the fuel oil range DN50
- Stainless steel cabinet, lockable
- Drip tray, overflow confirmation box, tank truck plug
- Pipe lead-through on the back side
- Up to 3 strings in the cabinet

#### Special equipment:

- Tanker connections in nominal width DN80/3"
- VK/MK couplings, Camlock as well as leakage-free Todo couplings
- Piping in stainless steel (e.g. refueling urea solution)
- Lighting, light switch
- Door sensor for light or alarm signal
- Pipe feed-through at the side, top or bottom
- Venting or gas displacement line

Materials	Approval	Documentation	Page
stainless steel, steel, brass		DB-B-AE-907-W_2018.11 DB_AE-200_AE-201_2018-05_DE	1 / 3

BFS-

# Filling and removal box

## Usage and functionality



# Krampitz

TANKSYSTEM GMBH

CUBIC GOOD

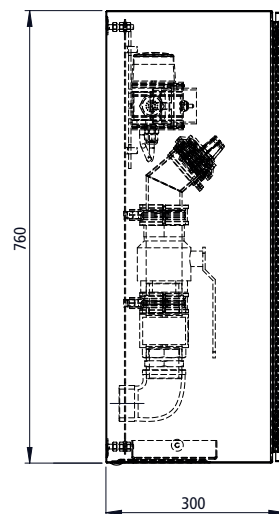
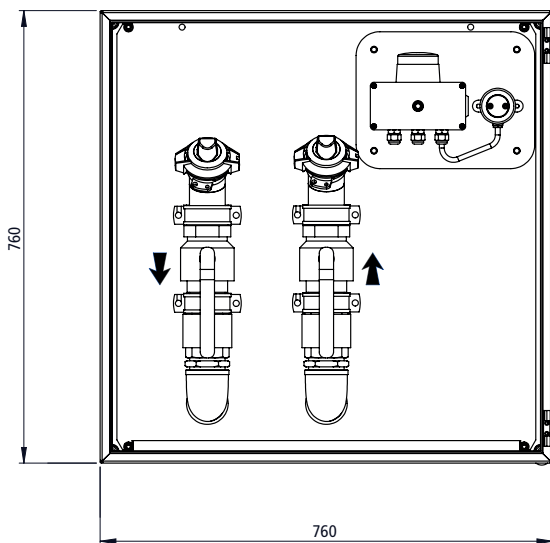

Tanker connection pipe  
standing version  
1x filling 1x suction

Figure: BFS-BE-S-D

Pos	Article description	Typ	Material	Specification
1	Elbow IG/AG	DN50/2"	Steel galvanized	
2	Check valve IG/IG	DN50/2"	Brass	PN40
3	Double nipple AG/AG	DN50/2"	Brass	
4	Ball valve IG/IG	DN50/2"	Brass	
5	Pipe angle welded	130°/2"	Steel	TSM-FT-X-01
6	Filling pipe coupling Typ K2	K50-IG-2"	Brass/ABS	EN 14420-6
7	Pipe clamp FRS Plus	DN65/2½"	Steel galvanized	
8	Weld-on stud with thread	RD/MR/4.8 M10x15 mm	Stainless steel	DIN EN ISO 13918

### Tanker connection nozzle

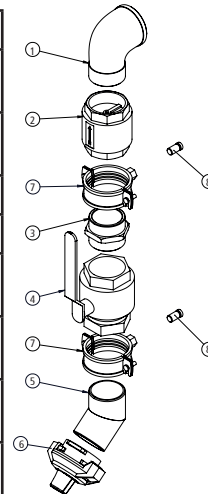

hanging

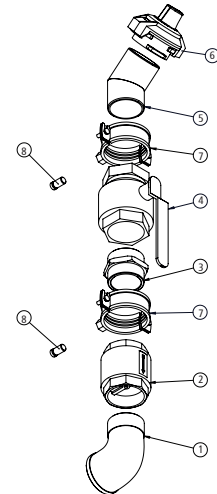

standing

## Electrical function diagram overfill confirmation box

### B-AE-907-W

Overfill confirmation box with tanker shutdown electronics

### AE-201

Level limiter

### AE-200

Overfill protection

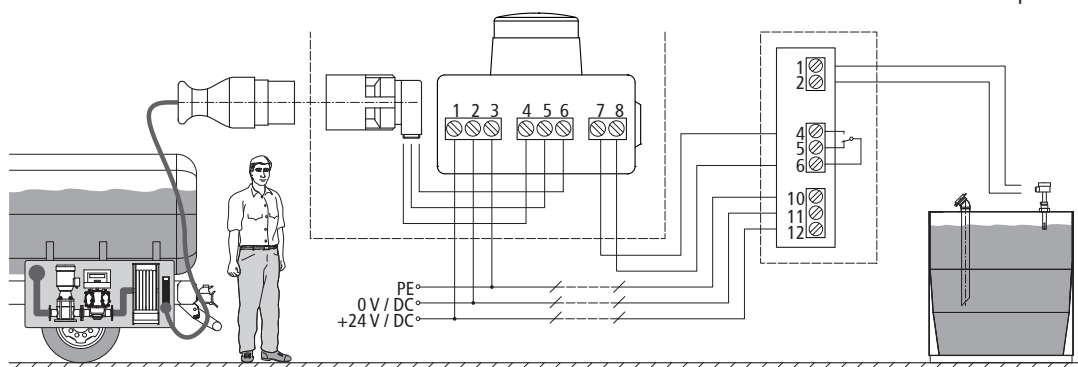

Materials	Approval	Documentation	Page
stainless steel, steel, brass		DB-B-AE-907-W_2018.11 DB_AE-200_AE-201_2018-05_DE	2 / 3

Technical details are subject to change!

BFS-

# Filling and removal box

## Usage and functionality



# Krampitz

TANKSYSTEM  
GMBH

CUBIC  
GOOD

### Difference in use hanging and standing design of the tanker connection pipe

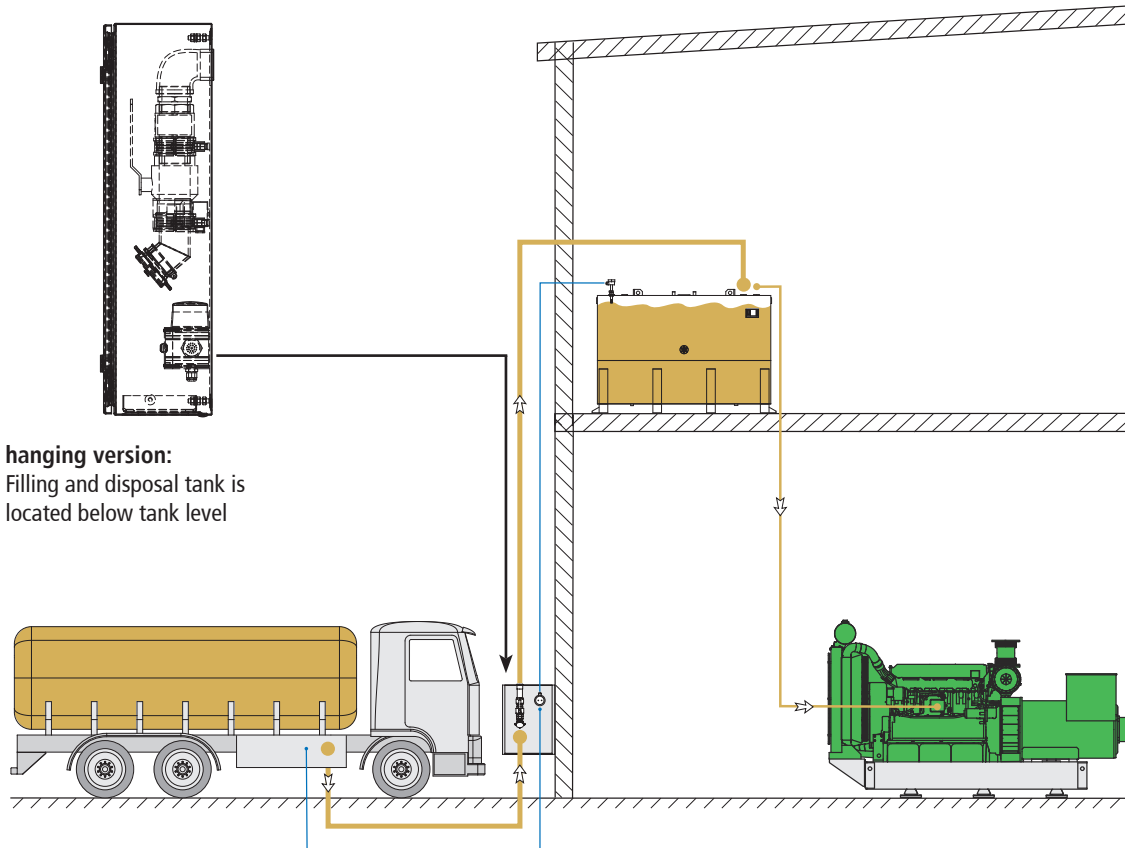

**standing version:**  
Filling and disposal tank is located above tank level

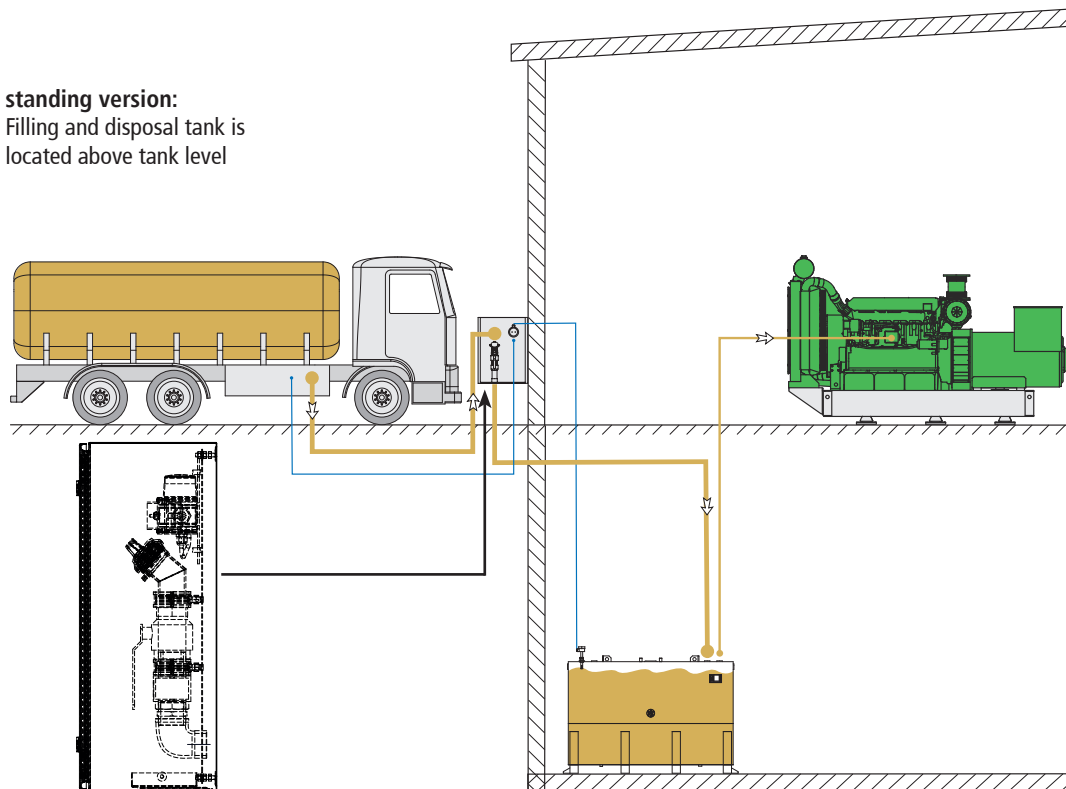

#### Materials

stainless steel, steel, brass

#### Approval

#### Documentation

DB-B-AE-907-W\_2018.11  
DB\_AE-200\_AE-201\_2018-05\_DE

#### Page

3 / 3

Technical details are subject to change!